

FOURTH FLOOR
FINISHED FLOOR LEVEL - 99.200
SLAB LEVEL - 99.180
CEILING LEVEL - 101.835

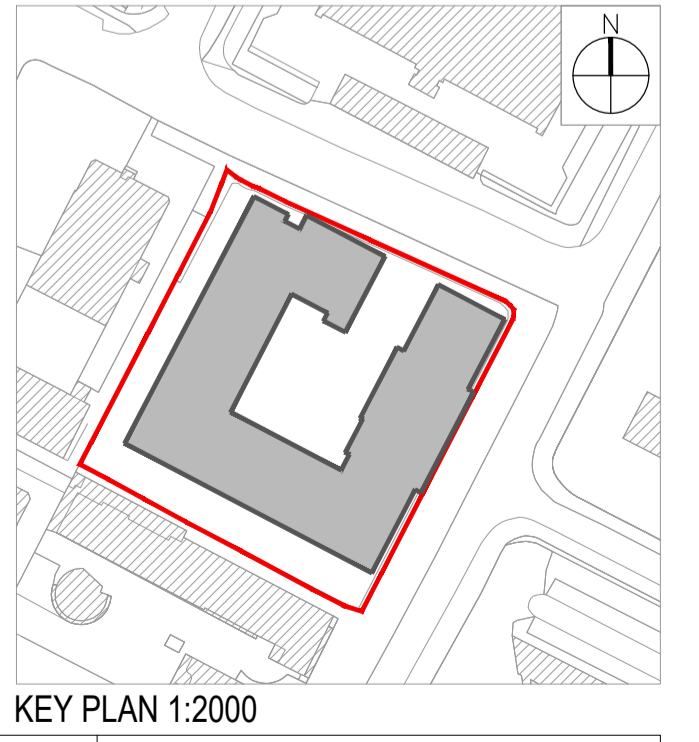

- LEGEND**
- RESIDENTS AMENITIES
 - RESIDENTS AMENITIES (SPECIFIED HOURS FOR USE BY LOCAL COMMUNITY)
 - SHARED AMENITIES (FOR USE BY RESIDENTS AND LOCAL COMMUNITY)
 - STUDIO
 - 1 BED APARTMENT - 2 PERSON
 - 2 BED APARTMENT - 3 PERSON
 - 2 BED APARTMENT - 4 PERSON
 - 3 BED APARTMENT - 5 PERSON
 - SHARED RESIDENTIAL AMENITY ENTRANCES
 - RESIDENTIAL ENTRANCES
 - APPLICATION SITE BOUNDARY (RED LINE)
- REFER TO LANDSCAPE ARCHITECTS DRAWING FOR FURTHER DETAILS OF HARD AND SOFT LANDSCAPING AND BOUNDARY FINISHES

FLOOR	STUDIO	1 BED 2 P	2 BED 3P	2 BED 4P	3 BED 5P	TOTAL
1	3	36	-	11	-	46
2	2	33	-	10	2	47
3	2	33	-	10	2	47
4	2	27	2	12	-	43
5	2	27	2	12	-	43
6	3	28	-	10	-	41
7	11	21	2	7	-	41
8	8	16	-	4	-	28
9	2	15	-	3	-	20
10	2	15	-	3	-	20
11	-	7	-	1	-	8
12	-	7	-	1	-	8
13	-	7	1	-	-	8
14	-	7	1	-	-	8
15	3	4	1	-	-	8
16	1	6	1	-	-	8
TOTAL	41	285	10	84	8	428



Notes

- Copyright Reserved
- Work to agreed dimensions only. Do not scale drawing
- The contractor is responsible for checking all levels and dimensions on site and shall refer all discrepancies to the Architect
- Where appropriate, for details of i.r.c. structure, or mechanical and electrical details, see Engineers drawings
- Proprietary items shall be fixed in strict accordance with manufacturers instructions.
- Sizes of proprietary items shall be checked with manufacturer.
- The contractor shall be responsible for the coordination of structure, finishes and services.

Issue Status

Progress	
Planning Application	
Fire Cert	
Disability Cert	
Tender	
Construction	
As Built	
Information Only	

W:\Project Section - Current\6246 Residential Development Sandford Avid Site\CAD\Drawings\Construction\Plans\6246 - Plans.dwg 05/03/2021 22:01:34

No.	Date	Revision	Initials
PL1	JUNE 2020	PLANNING APPLICATION ISSUE	FF
PL2	JAN 2021	PLANNING APPLICATION ISSUE	ML

Project: Carmanhall Road SHD Atlas GP Ltd.

Drawing Title: Proposed Fourth Floor Plan

Drawing No: 6246-106

Scale: 1:200@A1 Rev: PL2 Drawn: ML Date: 05/03/20

6-7 HARcourt TERRACE, DUBLIN 2, IRELAND
T: +353 1 618 2400 F: +353 1 676 7366
www.bkd.ie

bkd architects
BURKE-KENNEDY DOYLE